



**The Timken Company**

4500 Mt Pleasant St. NW

N. Canton, OH 44720

**Phone:** (234) 262-3000

**E-Mail:** [CustomerCAD@timken.com](mailto:CustomerCAD@timken.com) • **Web site:** [www.timken.com](http://www.timken.com)

## Part Number RA104RRB, Fafnir® Eccentric Locking Collar Ball Bearings



**RA-RR, RA-RRB Standard Series**

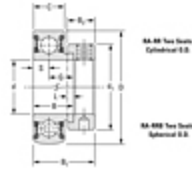

[Specifications](#) | [Dimensions](#) | [Basic Load Ratings](#)

### Specifications

|                                  |                    |
|----------------------------------|--------------------|
| <b>Manufacturing Part Number</b> | RA104RRB + COL     |
| <b>Series</b>                    | Standard           |
| <b>Shaft Size d</b>              | 1 1/4 in           |
| <b>Bore Type</b>                 | Cylindrical bore   |
| <b>Bearing Type</b>              | Ball Bearing       |
| <b>Material</b>                  | Bearing Steel      |
| <b>Lubrication Type</b>          | Non-Relubricatable |
| <b>O.D. Type</b>                 | Spherical OD       |
| <b>Sub Series</b>                | RA..RRB            |
| <b>Seal Type</b>                 | Molded Shroud      |



## Dimensions

|                                     |                     |
|-------------------------------------|---------------------|
| <b>Outside Diameter D</b>           | 2.835 in<br>72 mm   |
| <b>Inner Ring Width B</b>           | 1 in<br>25.4 mm     |
| <b>Outside Ring Width C</b>         | 0.748 in<br>19 mm   |
| <b>Radius r</b>                     | 0.024 in<br>0.6 mm  |
| <b>Center of Bearing from End S</b> | 0.374 in<br>9.5 mm  |
| <b>Set Screw Size</b>               | 5/16-18             |
| <b>Number of Set Screws</b>         | 2                   |
| <b>Angle between Set Screws</b>     | 90 °                |
| <b>Dimension d1</b>                 | 2.126 in<br>54 mm   |
| <b>Dimension B1</b>                 | 1.531 in<br>38.9 mm |
| <b>Dimension B2</b>                 | 0.673 in<br>17.1 mm |

## Basic Load Ratings

|                            |                     |
|----------------------------|---------------------|
| <b>Static Load Rating</b>  | 3440 lbf<br>15300 N |
| <b>Dynamic Load Rating</b> | 6400 lbf<br>28500 N |

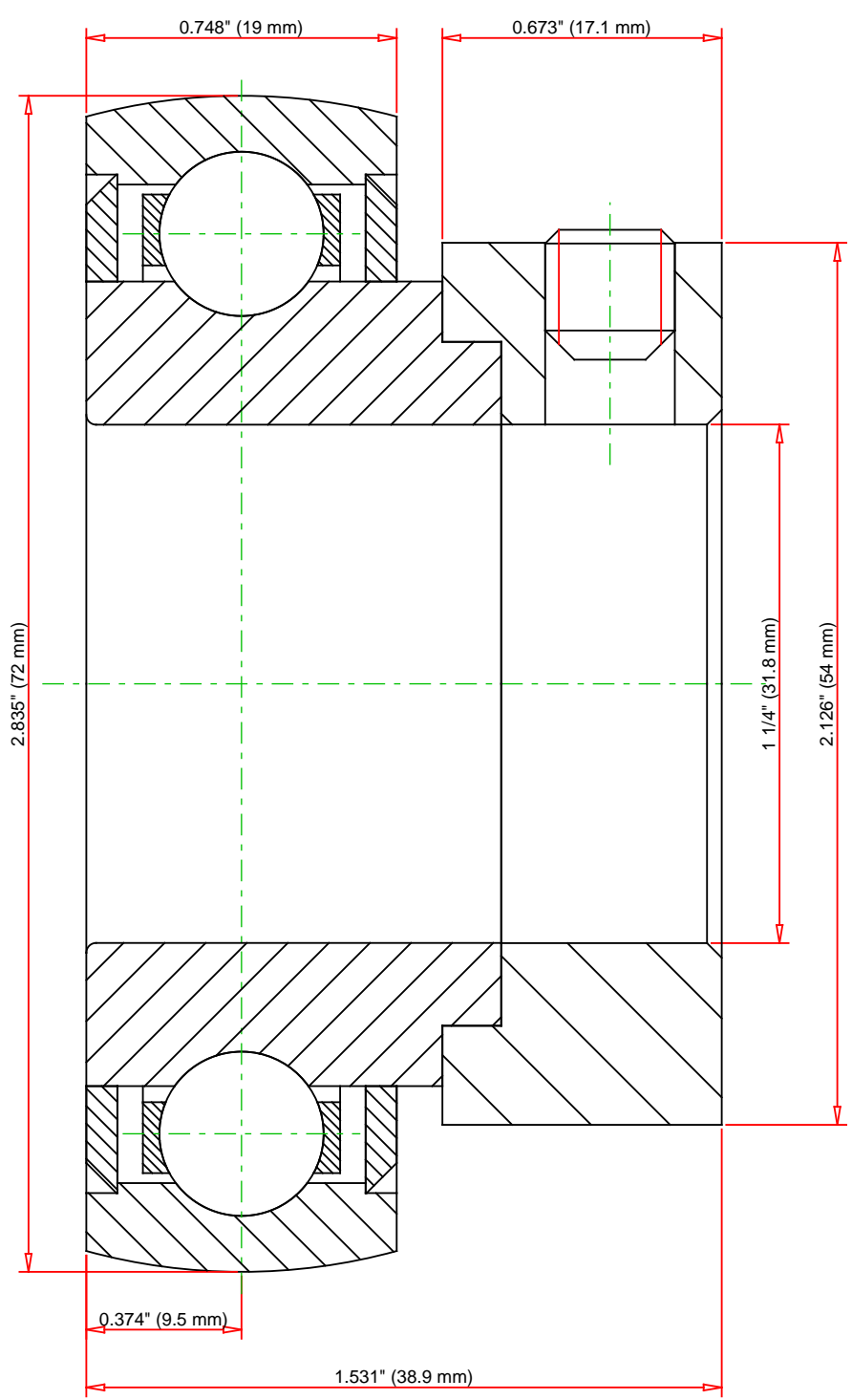

|  |        |        |                     |  |   |         |  |
|--|--------|--------|---------------------|--|---|---------|--|
| Weight   | 0.5 lb | 0.2 kg | <div>TIMKEN®</div>  |  | <div>RA104RRB</div> <div>Fafnir® Eccentric Locking Collar Ball Bearings</div> |         |  |
|  |        |        |                     |  |   |         |  |
|  |        |        |                     |  |   |         |  |
|  |        |        | Static Load Rating  |  | 3440 lbf  | 15300 N |  |
|  |        |        | Dynamic Load Rating |  | 6400 lbf  | 28500 N |  |
| Every reasonable effort has been made to ensure the accuracy of the information contained in this writing, but no liability is accepted for errors, omissions or for any other reason. |        |        |                     |  | FOR DISCUSSION ONLY   |         |  |