

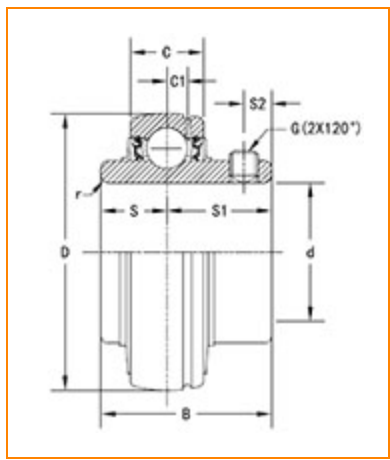

**The Timken Company**  
4500 Mt Pleasant St. NW  
N. Canton, OH 44720  
**Phone:** (234) 262-3000  
**E-Mail:** [CustomerCAD@timken.com](mailto:CustomerCAD@timken.com) • **Web site:** [www.timken.com](http://www.timken.com)

Part Number UC205, UC 200 Wide Inner Ring Ball Bearings - Set Screw Locking



[Specifications](#) | [Dimensions](#) | [Basic Load Ratings](#)

Specifications

Bore Type	Cylindrical bore
Bearing Type	Ball Bearing
Shaft Size d	25 mm
Locking Device	Set Screw Locking

Dimensions

Outside Diameter D	2.047 in 52 mm
Outside Ring Width C	0.669 in 17 mm
Radius r	0.039 in 1 mm



<b>Groove Position C1</b>	0.177 in 4.5 mm
<b>Center of Bearing from End S</b>	0.563 in 14.3 mm
<b>Dimension S1</b>	0.780 in 19.8 mm
<b>Set Screw Distance S2</b>	0.217 in 5.5 mm
<b>Set Screw Size</b>	M6×0.75
<b>Number of Set Screws</b>	2
<b>Angle between Set Screws</b>	120 °

## Basic Load Ratings

<b>Static Load Rating</b>	1765 lbf 7850 N
<b>Dynamic Load Rating</b>	3147 lbf 14000 N

