

The Timken Company

4500 Mt Pleasant St. NW

N. Canton, OH 44720

Phone: (234) 262-3000

E-Mail: CustomerCAD@timken.com • **Web site:** www.timken.com

Housing – Bearing – Seal SNT 518-615 - 21315 - VR315, SNT/FSNT Cylindrical Bore Plummer Block Mounted Bearings

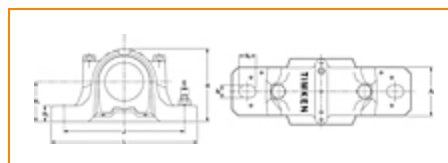

 TIMKEN®
REPRESENTATIVE IMAGE

[Types of Components](#) | [Housing](#) | [Bearing](#) | [Dimensions](#) | [Specifications](#)

Types of Components

Housing	SNT 518-615
Bearing	21315
Locating Rings (width x OD)	SR160X14
Seal Type	V-ring
Seal	VR315
End Cover¹	EC518-615

Housing

Material	Cast Iron
 Bolt Qty	2

Housing Mass

13.1 Kg

Bearing

Cage Type

EJ

C1 Dynamic Load Rating

322000

C0 Static Load Rating

321000

Max Oil Speed

4300

Max Grease Speed

3600

Dimensions

Shaft Diameter da

75 mm

Shaft Diameter db

85 mm

A

140 mm

A1

100 mm

G

M20

H

194 mm

H1

100 mm

H2

35 mm

Jmax

295 mm

Jmin

285 mm

J

290 mm

L

345 mm

N1

28 mm

N

22 mm

Specifications

UPC Code

999999999

Alternate Part Name

SNT518-615 - 21315 - VR315

¹ Two seals are required for a thru shaft application. One end cover can be used if application is not a thru shaft design. In this case, only one seal is required.

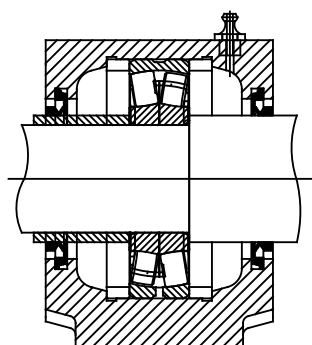
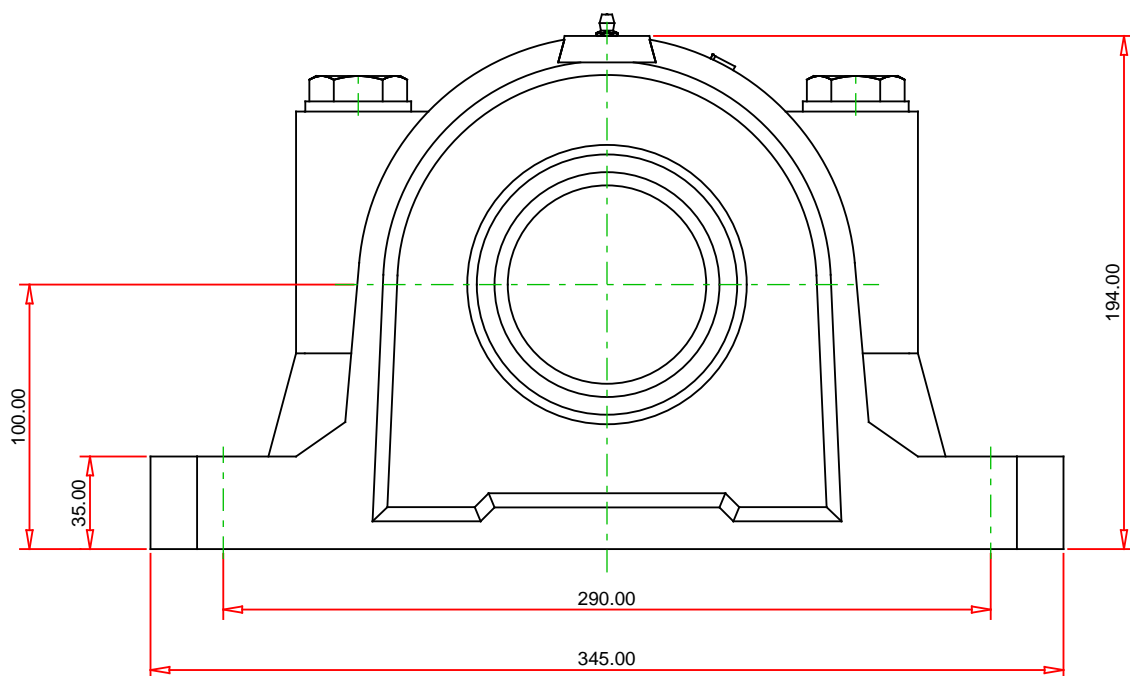
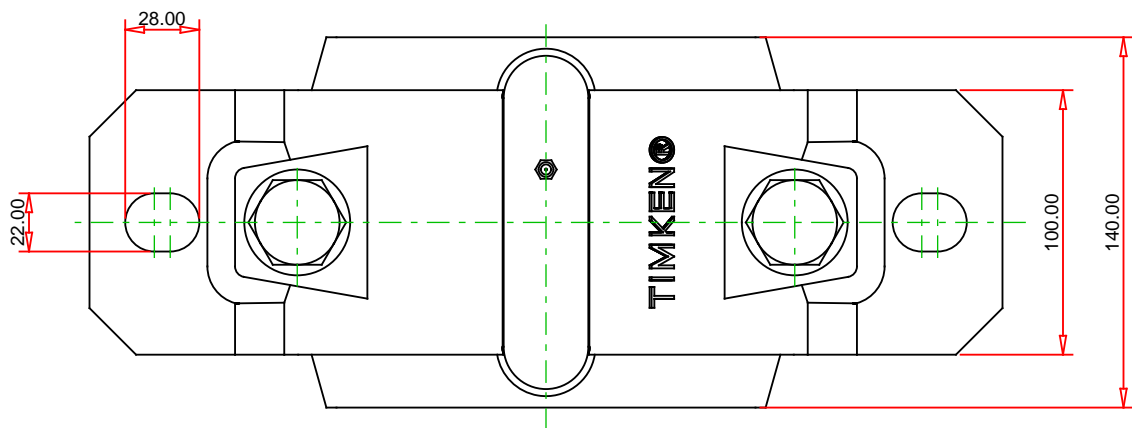

Note: Section View not to Scale

METRIC UNITS

Housing SNT 518-615
 Bearing 21315
 Seal (Quantity 2) VR315
 Seal Type V-ring
 Locating Ring (Quantity 2) SR160X14

TIMKEN

THE TIMKEN COMPANY
 NORTH CANTON, OHIO USA

SNT 518-615 - 21315 - VR315
 SNT/FSNT Cylindrical Bore Plummer Block Mounted Bearings

C1 Dynamic Load Rating (2 rows)	322000 N
C0 Static Load Rating	321000 N
Max Oil Speed	4300 RPM
Max Grease Speed	3600 RPM
Material	Cast Iron

Every reasonable effort has been made to ensure the accuracy of the information contained in this writing, but no liability is accepted for errors, omissions or for any other reason.

FOR DISCUSSION ONLY