



The Timken Company

4500 Mt Pleasant St. NW

N. Canton, OH 44720

Phone: (234) 262-3000

E-Mail: CustomerCAD@timken.com • **Web site:** www.timken.com

Part Number GYAE30RRB, Fafnir® Wide Inner Ring Setscrew Locking Ball Bearings

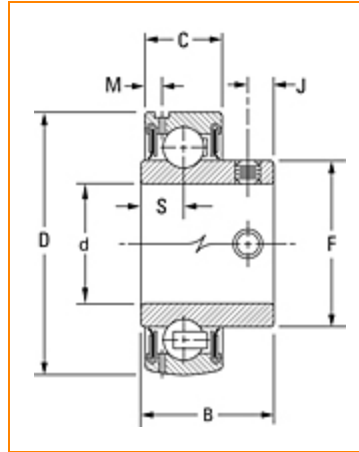

[Specifications](#) | [Dimensions](#) | [Basic Load Ratings](#)

Specifications

Series	Standard
Shaft Size d	30 mm
Bore Type	Cylindrical bore
Bearing Type	Ball Bearing
Material	Bearing Steel
Lubrication Type	Relubricatable
O.D. Type	Spherical OD
Sub Series	GYAE..RRB
Seal Type	Narrow Shroud



isions

Outside Diameter D	62 mm
Inner Ring Width B	32.5 mm
Outside Ring Width C	18 mm
Radius r	0.6 mm
Center of Bearing from End S	9.65 mm
Dimension S1	22.85 mm
Dimension F	40.1 mm
Dimension J	7.87 mm
Dimension M	4.17 mm
Set Screw Size	M8x1.25
Number of Set Screws	2
Angle between Set Screws	90 °

Basic Load Ratings

Static Load Rating	11300 N
Dynamic Load Rating	21600 N

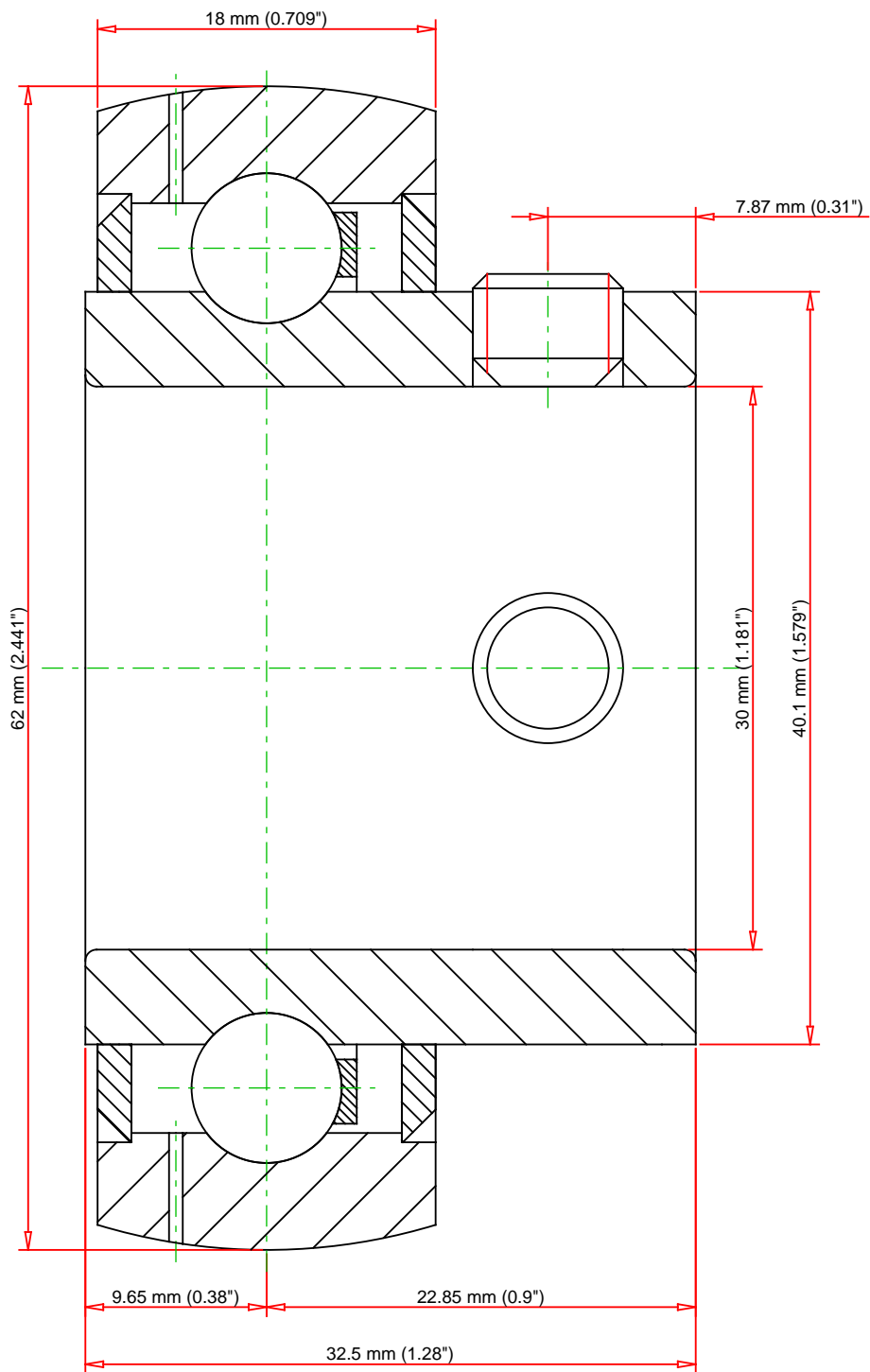

Weight	0.5 lb	0.2 kg	<div>TIMKEN®</div> <div>THE TIMKEN COMPANY</div> <div>NORTH CANTON, OHIO USA</div>	<div>GYAE30RRB</div> <div>Fafnir® Wide Inner Ring Setscrew Locking Ball Bearings</div>		
				Basic Load Ratings - C _r	4850 lbf	21600 N
				Load Ratings - C _{0r}	2530 lbf	11300 N
Every reasonable effort has been made to ensure the accuracy of the information contained in this writing, but no liability is accepted for errors, omissions or for any other reason.				FOR DISCUSSION ONLY		