

**The Timken Company**

4500 Mt Pleasant St. NW

N. Canton, OH 44720

**Phone:** (234) 262-3000

**E-Mail:** [CustomerCAD@timken.com](mailto:CustomerCAD@timken.com) • **Web site:** [www.timken.com](http://www.timken.com)

## Part Number YA012RR, Fafnir® Wide Inner Ring Setscrew Locking Ball Bearings

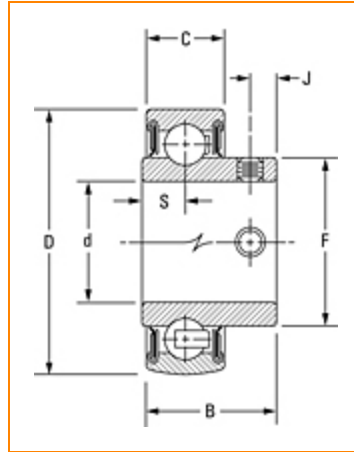

[Specifications](#) | [Dimensions](#) | [Basic Load Ratings](#)

### Specifications

<b>Series</b>	Standard
<b>Shaft Size d</b>	3/4 in
<b>Bore Type</b>	Cylindrical bore
<b>Bearing Type</b>	Ball Bearing
<b>Material</b>	Bearing Steel
<b>Lubrication Type</b>	Non-Relubricatable
<b>O.D. Type</b>	Cylindrical OD
<b>Sub Series</b>	YA..RR
<b>Seal Type</b>	Narrow Shroud



isions

<b>Outside Diameter D</b>	1.85 in 47 mm
<b>Inner Ring Width B</b>	1.063 in 27 mm
<b>Outside Ring Width C</b>	0.551 in 14 mm
<b>Radius r</b>	0.024 in 0.6 mm
<b>Center of Bearing from End S</b>	0.349 in 8.86 mm
<b>Dimension S1</b>	0.714 in 18.14 mm
<b>Dimension F</b>	1.142 in 29 mm
<b>Dimension J</b>	0.237 in 6.02 mm
<b>Set Screw Size</b>	M6x1
<b>Number of Set Screws</b>	2
<b>Angle between Set Screws</b>	90 °

## Basic Load Ratings

<b>Static Load Rating</b>	1460 lbf 6500 N
<b>Dynamic Load Rating</b>	3190 lbf 14200 N

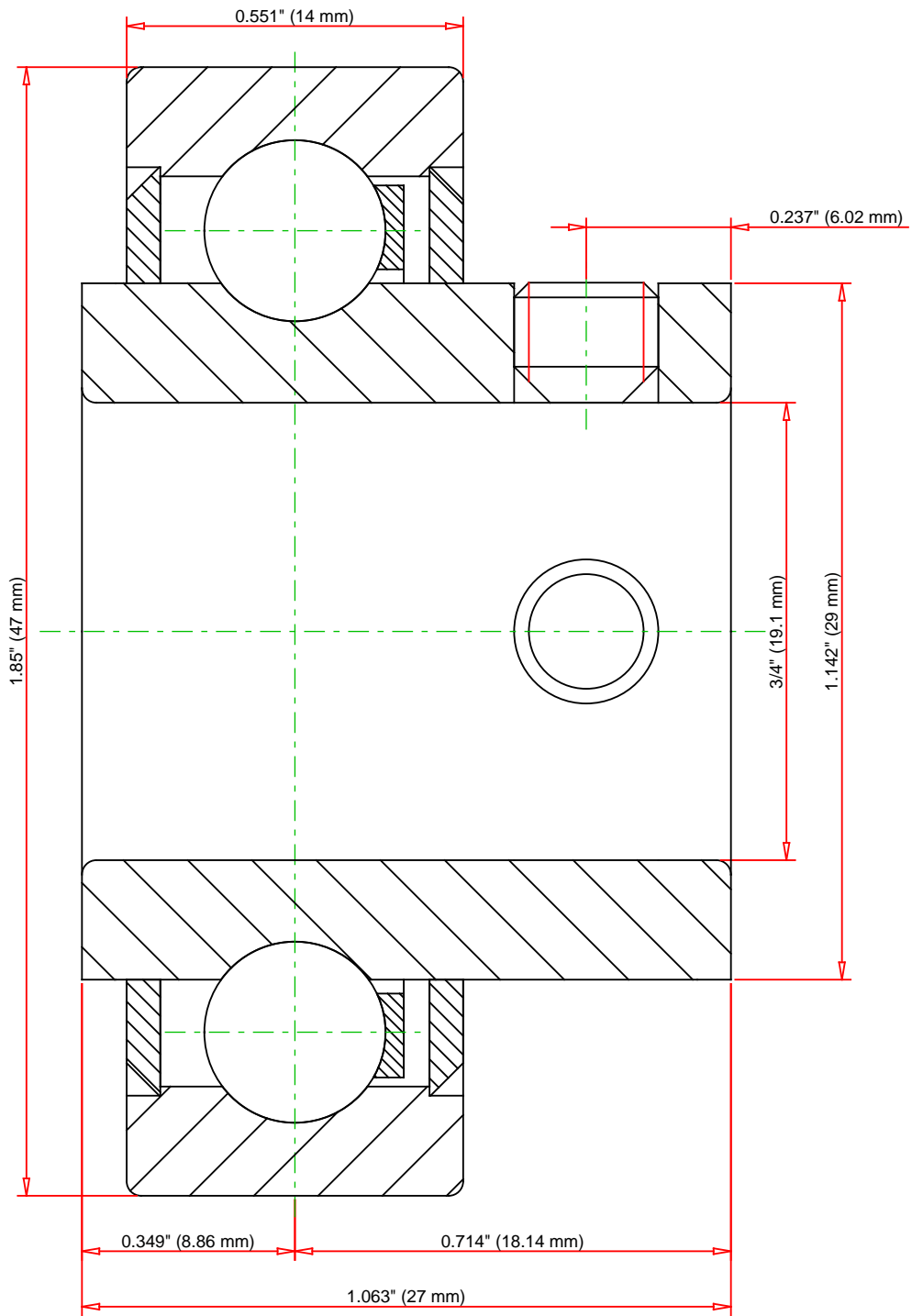

Weight		0.5 lb	0.2 kg	<div>TIMKEN®</div> <div>THE TIMKEN COMPANY</div> <div>NORTH CANTON, OHIO USA</div>	<div>YA012RR</div> <div>Fafnir® Wide Inner Ring Setscrew Locking Ball Bearings</div>			
					Basic Load Ratings - C <sub>r</sub>		3190 lbf	14200 N
					Load Ratings - C <sub>0r</sub>		1460 lbf	6500 N
					FOR DISCUSSION ONLY			

Every reasonable effort has been made to ensure the accuracy of the information contained in this writing, but no liability is accepted for errors, omissions or for any other reason.